

698137



F=0

TORNADO PROJECT SUMMARY SHEET

1. DATE AND TIME Sept. 16, 1981 five?

2. LOCATION OR PATH (attach map) Footer Bay, Ont.

3. PATH LENGTH [ ] NOT KNOWN [ ] <1 mi; [ ] 1-4 mi; [ ] 5-10 mi; [ ] 11-50 mi; [ ] LENGTH IF > 50 mi

4. PATH WIDTH [ ] 5. TORNADO PART OF SQUALL LINE? [ ] YES; [ ] NO; [ ] UNKNOWN:

6. ANY UNUSUAL COLORATION? [ ] YES; [ ] NO; [ ] UNKNOWN

7. ANY UNUSUAL SOUND? [ ] YES; [ ] NO; [ ] UNKNOWN

8. IF ANSWER TO 6 OR 7 YES, ELABORATE;

9. LIST ANY ASSOCIATED PHENOMENA (Such as hail, vivid lightning heavy rain, no rain, etc.)

10. TOTAL DAMAGE ESTIMATE \$ 11. TOTAL DEATHS

12. TOTAL INJURED 13. TOTAL HOMELESS

14. LIST ALL REFERENCES

15. SUMMARIZE REMARKS PERTAINING TO (a) FUNNEL; (b) INTERESTING OR CAPRICIOUS EVENTS.

b) Trees down.

T.D. 175 98 900 2000 0  
49 98 000



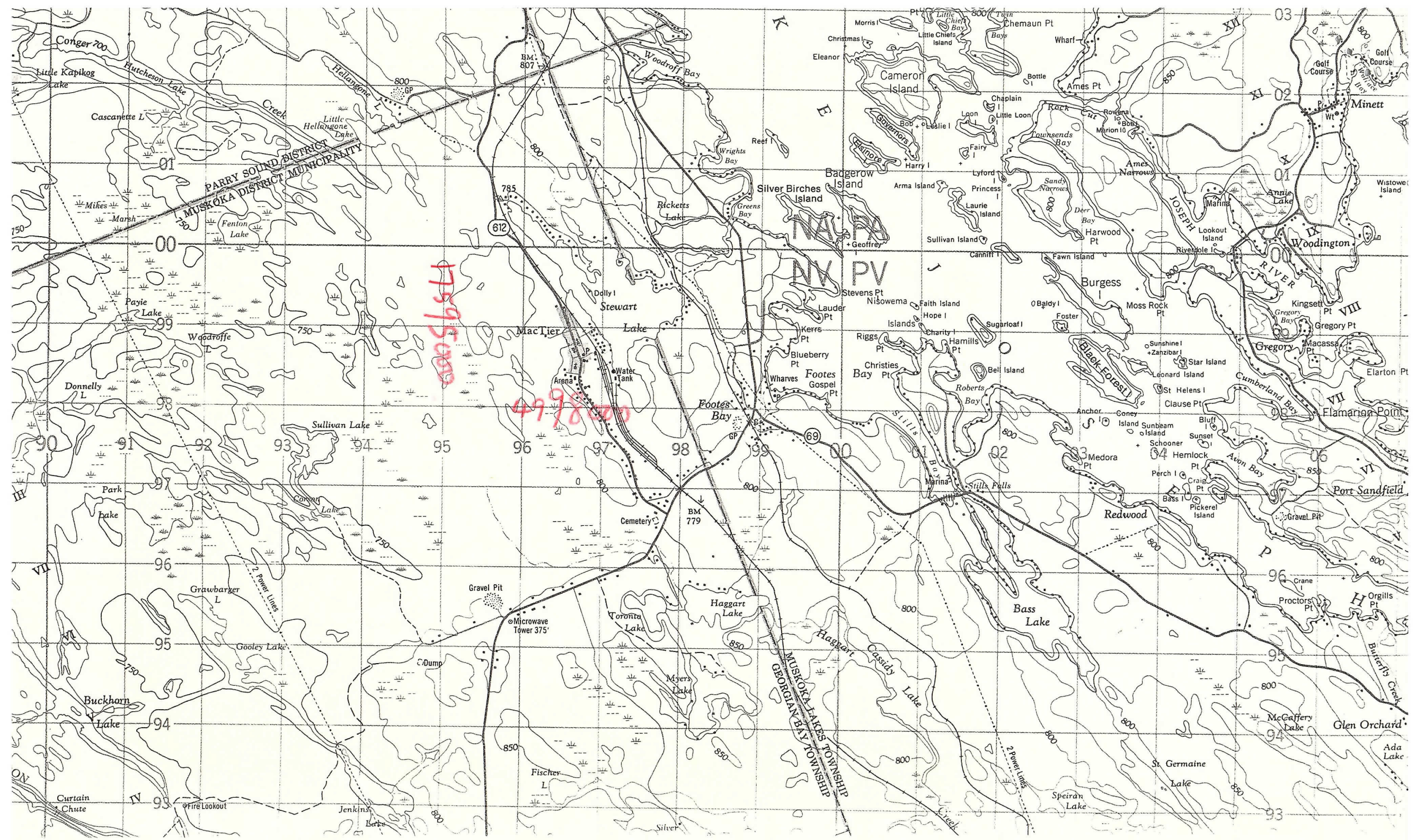

PARRY SOUND DISTRICT  
MUSKOKA DISTRICT MUNICIPALITY

MUSKOKA LAKES TOWNSHIP  
GEORGIAN BAY TOWNSHIP

17595000

4998500

Conger 700

Little Kapikog Lake

Cascanette L

Hutcherson Lake

800

GP

750

750

750

750

750

750

750

750

750

750

750

750

750

750

750

785

612

750

750

750

750

750

750

750

750

750

750

750

750

750

750

Woodroff Bay

Wrights Bay

Ricketts Lake

Greens Bay

MacTier Lake

Stewart Lake

Water Tank

Arena

Footes Bay

GP

800

800

800

800

800

800

800

800

800

Cameroon Island

Badgerow Island

Silver Birches Island

Stevens Pt

Lauder Pt

Kerrs Pt

Blueberry Pt

Wharves

Footes Gospel Pt

GP

800

800

800

800

800

800

800

Chemaun Pt

Armes Pt

Lawson's Bay

Sandy Narrows

Deer Bay

Harwood Pt

Fawn Island

Moss Rock Pt

St Helens I

Clause Pt

Bluff Pt

Sunset Pt

Hemlock Pt

Perch I

Craig Pt

Bass I

Pickering Island

Wharf

Armes Pt

Lawson's Bay

Sandy Narrows

Deer Bay

Harwood Pt

Fawn Island

Moss Rock Pt

St Helens I

Clause Pt

Bluff Pt

Sunset Pt

Hemlock Pt

Perch I

Craig Pt

Bass I

Pickering Island

Minett

Woodington

Gregory Pt

Macassa Pt

Elarton Pt

Flammarion Pt

Port Sandfield

Gravel Pit

Crane

Proctors Pt

Orgills Pt

Butter's Creek

Glen Orchard

Ada Lake

St Germaine Lake

Spiran Lake

800

800

800

800

800

800

800

800

800

800

800

800

800

800

800

800

800

Curtain Chute

Fire Lookout

Jenkins

Barks

Gravel Pit

Microwave Tower 375'

Gravel Pit

Camp

Fischer L

Myers Lake

Toronto Lake

Haggart Lake

Haggart Lake

Cassidy Lake

Bass Lake

Redwood

Medora Pt

Schooner Island

Anchor Island

Cone Island

Sunbeam Island

Bluff Pt

Sunset Pt

Hemlock Pt

Park Lake

Donnelly L

Payie Lake

Woodroffe L

Donnelly L

Donnelly L

Donnelly L

Donnelly L

Donnelly L

Donnelly L

Donnelly L

Donnelly L

Donnelly L

Donnelly L

Donnelly L

Donnelly L

Donnelly L

Donnelly L

Donnelly L

Donnelly L

Donnelly L

Donnelly L

Donnelly L

Donnelly L

Donnelly L

Donnelly L

Donnelly L

Donnelly L

Donnelly L

Donnelly L

Donnelly L

Donnelly L

Donnelly L

Donnelly L

Donnelly L

Donnelly L

Donnelly L

Donnelly L

Donnelly L

Donnelly L

Donnelly L

Donnelly L

Donnelly L

Donnelly L

Donnelly L

Donnelly L

Donnelly L

Donnelly L

Donnelly L

Donnelly L

Donnelly L

Donnelly L

Donnelly L

Donnelly L

Donnelly L

Donnelly L

Donnelly L

Donnelly L

Donnelly L

Donnelly L

Donnelly L

Donnelly L

Donnelly L

Donnelly L

Donnelly L

Donnelly L

Donnelly L

Donnelly L

Donnelly L

Donnelly L

Donnelly L

Donnelly L

Donnelly L

Donnelly L

Donnelly L

Donnelly L

Donnelly L

Donnelly L

Donnelly L

Donnelly L

Donnelly L

Donnelly L

Donnelly L

Donnelly L

Donnelly L

Donnelly L

Donnelly L

Donnelly L

Donnelly L

Donnelly L

Donnelly L

Donnelly L

Donnelly L

Donnelly L

Donnelly L

Donnelly L

Donnelly L

Donnelly L

Donnelly L

Donnelly L

Donnelly L

Donnelly L

Donnelly L

Donnelly L

Donnelly L

Donnelly L

Donnelly L

Donnelly L

Donnelly L

Donnelly L

Donnelly L

Donnelly L

Donnelly L

Donnelly L

Donnelly L

Donnelly L

Donnelly L

Donnelly L

Donnelly L

Donnelly L

Donnelly L

Donnelly L

Donnelly L

Donnelly L

Donnelly L

Donnelly L

Donnelly L

Donnelly L

Donnelly L

Donnelly L

Donnelly L

Donnelly L

Donnelly L

Donnelly L

Donnelly L

Donnelly L

Donnelly L

Donnelly L

Donnelly L

Donnelly L

Donnelly L

Donnelly L

Donnelly L

Donnelly L

Donnelly L

Donnelly L

Donnelly L

Donnelly L

Donnelly L

Donnelly L

Donnelly L

Donnelly L

Donnelly L

Donnelly L

Donnelly L

Donnelly L

Donnelly L

Donnelly L



CLIMATOLOGICAL STATION REPORT

STATION LYNDHURST SHAWMERE  
SEPTEMBER, 1981

Time of observation 8.00 a.m. 7.30 p.m.



Observer Elizabeth Shaw

MONTH September 19 81

TEMPERATURE (°C)					PRECIPITATION					TIMES OF PRECIPITATION (Calendar Day)		Weather (Calendar Day)	REMARKS				
Maximum		Minimum			Rain		Snow		Total For Day	Began	Ended			Depth of Snow on Ground	Thunderstorm	Freezing Rain	Hail
Observed	For Day	Observed	For Day	AFTER RESET	Measured	For Day	Measured	For Day									
3	4	5	6	7	8	9	10	11	12	13	14	15	16	17	18	19	
		17.5		18.5												Thin ☉ calm, dew 8am	
	25.5	25.5	18.5	17.5	23.5		6.0			6.0						☉ SW breeze, calm periods. ☉ all day.	
	23.5		19.0		19.0	6.0										☉ calm raining 8am. ☉ breeze am. ☉ SW breeze pm. ☉ calm 7:45 pm.	
	20.0	20.0	18.0	18.0	18.0	5.4	6.0			6.0						☉ calm 8am. ☉ showers, fog, & scotch mist overnight.	
	18.0		17.0		18.0	0.6										☉ variable breeze, calm periods, all day.	
	20.0	20.0	18.0	17.0	18.5		T			T						☉, ☉ SW breeze with calm periods all day.	
	18.5		16.5		17.5	T										☉ NE breeze with calm periods most of day. ☉ intervals pm.	
	19.0	19.0	16.0	16.0	16.0	4.2	17.8			17.8						☉ calm 8am. ☉ variable breeze most of day. ☉ calm 7:45 pm.	
	16.5		15.0		15.0	13.6										☉ E breeze, scotch mist 8am. ☉ SW breeze. Humid all day. ☉ calm 7:30 pm.	
	21.0	21.0	14.0	14.0	18.0	1.8	6.8			6.8						☉ NE breeze with calm periods most of day. ☉ intervals pm.	
	18.0		15.5		17.0	5.0										☉ calm 8am. ☉ variable breeze most of day. ☉ calm 7:45 pm.	
	24.5	24.5	17.0	15.5	20.5		0.4			0.4						☉ E breeze, scotch mist 8am. ☉ SW breeze. Humid all day. ☉ calm 7:30 pm.	
	20.5		15.0		16.0	0.4										☉ NE breeze with calm periods most of day. ☉ intervals pm.	
	24.0	24.0	16.0	15.0	20.0	0.2	0.2			0.2						☉ calm 8am. ☉ variable breeze most of day. ☉ calm 7:45 pm.	
	20.0		18.0		19.5											☉ E breeze, scotch mist 8am. ☉ SW breeze. Humid all day. ☉ calm 7:30 pm.	
	23.0	23.0	17.5	17.5	17.5	24.4	24.4			24.4						☉ NE breeze with calm periods most of day. ☉ intervals pm.	
	17.5		9.0		9.5											☉ calm 8am. ☉ variable breeze most of day. ☉ calm 7:45 pm.	
	13.5	14.0	9.5	9.0	11.5	0.2	0.2			0.2						☉ E breeze, scotch mist 8am. ☉ SW breeze. Humid all day. ☉ calm 7:30 pm.	
	14.0		7.0		14.0	T										☉ NE breeze with calm periods most of day. ☉ intervals pm.	
10	18.5	18.5	12.0	7.0	17.0	24.0	24.2			24.2						☉ calm 8am. ☉ variable breeze most of day. ☉ calm 7:45 pm.	
	18.0		10.0		13.0	0.2										☉ E breeze, scotch mist 8am. ☉ SW breeze. Humid all day. ☉ calm 7:30 pm.	
	17.0	17.0	12.5	10.0	16.0		0.4			0.4						☉ NE breeze with calm periods most of day. ☉ intervals pm.	
	16.0		10.5		15.0	0.4										☉ calm 8am. ☉ variable breeze most of day. ☉ calm 7:45 pm.	
	22.5	22.5	15.0	10.5	17.0											☉ E breeze, scotch mist 8am. ☉ SW breeze. Humid all day. ☉ calm 7:30 pm.	
	17.5		11.5		13.5											☉ NE breeze with calm periods most of day. ☉ intervals pm.	
	25.0	25.0	13.5	11.5	20.0											☉ calm 8am. ☉ variable breeze most of day. ☉ calm 7:45 pm.	
	20.0		13.0		15.0											☉ E breeze, scotch mist 8am. ☉ SW breeze. Humid all day. ☉ calm 7:30 pm.	
	23.5	23.5	15.0	13.0	18.0	T	T			T						☉ NE breeze with calm periods most of day. ☉ intervals pm.	
	18.0		9.5		10.5											☉ calm 8am. ☉ variable breeze most of day. ☉ calm 7:45 pm.	
	20.5	20.5	10.5	9.5	14.5	T	T			T						☉ E breeze, scotch mist 8am. ☉ SW breeze. Humid all day. ☉ calm 7:30 pm.	
	14.5		9.0		9.5											☉ NE breeze with calm periods most of day. ☉ intervals pm.	
		18.5		9.0												☉ calm 8am. ☉ variable breeze most of day. ☉ calm 7:45 pm.	
	18.5		8.0		9.0											☉ E breeze, scotch mist 8am. ☉ SW breeze. Humid all day. ☉ calm 7:30 pm.	
	11.0	12.0	9.0	8.0	11.0	10.4	10.4			10.4						☉ NE breeze with calm periods most of day. ☉ intervals pm.	
	12.0		8.5		11.0											☉ calm 8am. ☉ variable breeze most of day. ☉ calm 7:45 pm.	
	17.5	17.5	11.0	8.5	12.0											☉ E breeze, scotch mist 8am. ☉ SW breeze. Humid all day. ☉ calm 7:30 pm.	
	12.0		7.5		8.0											☉ NE breeze with calm periods most of day. ☉ intervals pm.	
19	17.0	17.0	8.0	7.5	14.5	T	0.8			0.8						☉ calm 8am. ☉ variable breeze most of day. ☉ calm 7:45 pm.	
	14.5		6.5		7.5	0.8										☉ E breeze, scotch mist 8am. ☉ SW breeze. Humid all day. ☉ calm 7:30 pm.	
	13.0	13.0	7.5	6.5	9.0											☉ NE breeze with calm periods most of day. ☉ intervals pm.	
	9.0		3.5		4.5											☉ calm 8am. ☉ variable breeze most of day. ☉ calm 7:45 pm.	
	15.0	15.0	4.5	3.5	11.0	T	7.4			7.4						☉ E breeze, scotch mist 8am. ☉ SW breeze. Humid all day. ☉ calm 7:30 pm.	
	11.0		8.5		8.5	7.4										☉ NE breeze with calm periods most of day. ☉ intervals pm.	
	9.5	9.5	8.0	8.0	9.0	0.4	13.6			13.6						☉ calm 8am. ☉ variable breeze most of day. ☉ calm 7:45 pm.	
	9.5		8.0		8.0	13.2										☉ E breeze, scotch mist 8am. ☉ SW breeze. Humid all day. ☉ calm 7:30 pm.	
	10.5	10.5	7.5	7.5	9.5	15.0	15.2			15.2						☉ NE breeze with calm periods most of day. ☉ intervals pm.	
	9.5		7.5		8.0	0.2										☉ calm 8am. ☉ variable breeze most of day. ☉ calm 7:45 pm.	
	16.0	16.0	8.0	7.5	11.5											☉ E breeze, scotch mist 8am. ☉ SW breeze. Humid all day. ☉ calm 7:30 pm.	
	12.5		7.0		7.5											☉ NE breeze with calm periods most of day. ☉ intervals pm.	
	17.5	17.5	7.5	7.0	14.0	T	T			T						☉ calm 8am. ☉ variable breeze most of day. ☉ calm 7:45 pm.	
	14.0		11.0		13.5											☉ E breeze, scotch mist 8am. ☉ SW breeze. Humid all day. ☉ calm 7:30 pm.	
	15.0	18.5	13.0	11.0	13.5	1.4	9.4			9.4						☉ NE breeze with calm periods most of day. ☉ intervals pm.	
	18.5		13.0		17.0	8.0										☉ calm 8am. ☉ variable breeze most of day. ☉ calm 7:45 pm.	
	21.5	21.5	17.0	13.0	17.0	9.6	9.6			9.6						☉ E breeze, scotch mist 8am. ☉ SW breeze. Humid all day. ☉ calm 7:30 pm.	
	17.0		10.0		10.0											☉ NE breeze with calm periods most of day. ☉ intervals pm.	
	12.0	12.0	8.0	8.0	9.0	1.4	1.4			1.4						☉ calm 8am. ☉ variable breeze most of day. ☉ calm 7:45 pm.	
m.	9.0		2.0		3.0											☉ E breeze, scotch mist 8am. ☉ SW breeze. Humid all day. ☉ calm 7:30 pm.	
m.	12.0	12.0	3.0	2.0	8.0											☉ NE breeze with calm periods most of day. ☉ intervals pm.	
m.	8.0		0.0		2.0											☉ calm 8am. ☉ variable breeze most of day. ☉ calm 7:45 pm.	
m.	10.0	10.0	2.0	0.0	7.0											☉ E breeze, scotch mist 8am. ☉ SW breeze. Humid all day. ☉ calm 7:30 pm.	
m.																☉ NE breeze with calm periods most of day. ☉ intervals pm.	
m.																☉ calm 8am. ☉ variable breeze most of day. ☉ calm 7:45 pm.	
m.	7.0															☉ E breeze, scotch mist 8am. ☉ SW breeze. Humid all day. ☉ calm 7:30 pm.	

Total no. of days with 3

53 8.5	30 8.0	15 4.2	nil.	15 4.2
17.95°	10.27°			

TEMPERATURE EXTREMES  
Maximum 25.5° Date 1<sup>st</sup> Mean 17.95°  
Minimum 0.0° Date 30<sup>th</sup> Mean 10.27°