

TORNADO PROJECT SUMMARY SHEET

ONT

1. DATE AND TIME WED JULY 26, 1978 (4) 1700 EDT; (6) 2100 EDT; (7) 2000 EDT

2. LOCATION OR PATH (attach map) 1 GUELPH (W-6) 0978-18
 2 CAMBRIDGE 0978-19
 3 VENTY WALKERTON 0978-20
 4 ONARING - WINDY LAKE (near base) 0978-21
 5. STEVENSVILLE
 6. LITTLE BOSKONSLEK

3. PATH LENGTH NOT KNOWN 0.8 <1mi; 1-4mi; 5-10mi; 11-50mi; LENGTH IF > 50mi

4. PATH WIDTH 250 FT

5. TORNADO PART OF SQUALL LINE? YES; NO; UNKNOWN:

6. ANY UNUSUAL COLORATION? YES; NO; UNKNOWN

7. ANY UNUSUAL SOUND? YES; NO; UNKNOWN

8. IF ANSWER TO 6 OR 7 YES, ELABORATE;

9. LIST ANY ASSOCIATED PHENOMENA (1) NO RAIN AT TIME OF FUNNEL CLO
 (Such as hail, vivid lightning heavy rain, no rain, etc.) FUNNEL CLODS ALSO REPORTED IN SCARBOROUGH, CAMBRIDGE AND WALKERTON

10. TOTAL DAMAGE ESTIMATE \$ U 11. TOTAL DEATHS NONE

12. TOTAL INJURED NONE 13. TOTAL HOMELESS NONE

14. LIST ALL REFERENCES
 STRATFORD BEACON HERALD, JULY 27, 1978.
 THE STAR, TORONTO, THUR JULY 27, 1978
 THE GLOBE & MAIL, TORONTO, THUR JULY 27, 1978
 LONDON EVENING FREE PRESS, THUR JULY 27, 1978
 TORONTO SUN, THUR JULY 27, 1978
 THE SUBURBY STAR, JULY 27, 1978
 KITCHENER-WATERLOO RECORD, JULY 27, 1978
 TOWN AND COUNTRY CRICK, MILDMEY, AUG 3, 1978

15. SUMMARIZE REMARKS PERTAINING TO (a) FUNNEL; (b) INTERESTING OR CAPRICIOUS EVENTS.

(a) Funnel seen by Constable Steven CAUDLE, Guelph City Police, who was within a few hundred feet of it at one point (Stevenson and Grange). He saw it moving aloft across the city towards him, saw it touch down at Grange & Stevenson where it was wide enough to cover the road from side to side. It then lifted up but touched down again at the railroad embankment, finally lifting at Elizabeth and Victoria. It was much wider at the top than the bottom, and dark grey in colour and about 100 to 120 ft from tip to base of cloud. The constable described a sudden lull just before funnel appeared, then his car began to shake as it passed by. There was no rain.

(b) 2500 lb, 7ft diameter steel conduit pipe carried 60ft smashing 5 cars on its course. A man pushed from the front to the back of his house. Trees broken and roofing taken off Gino's Automotive Centre. A car and boat pushed 30 to 50 ft.

TORNADO PROJECT SUMMARY SHEET

F=0

ONT

1. DATE AND TIME *WED, JULY 26, 1978.* *APPROX 1700 EDT*

2. LOCATION OR PATH
(attach map) *ONAPING - WINDY LAKE PARK*

3. PATH LENGTH NOT KNOWN <1mi; 1-4mi; 5-10mi; 11-50mi; LENGTH IF >50mi

4. PATH WIDTH U 5. TORNADO PART OF SQUALL LINE? YES; NO; UNKNOWN:

6. ANY UNUSUAL COLORATION? YES; NO; UNKNOWN

7. ANY UNUSUAL SOUND? YES; NO; UNKNOWN

8. IF ANSWER TO 6 OR 7 YES, ELABORATE;

9. LIST ANY ASSOCIATED PHENOMENA
(Such as hail, vivid lightning heavy rain, no rain, etc.)

10. TOTAL DAMAGE ESTIMATE \$ *U* 11. TOTAL DEATHS *NONE*

12. TOTAL INJURED *NONE* 13. TOTAL HOMELESS *NONE*

14. LIST ALL REFERENCES
THE SUDBURY STAR, JULY 27, 1978.

15. SUMMARIZE REMARKS PERTAINING TO (a) FUNNEL; (b) INTERESTING OR CAPRICIOUS EVENTS.
(a) no remarks but called a "twister".
(b) Numerous trees knocked over.

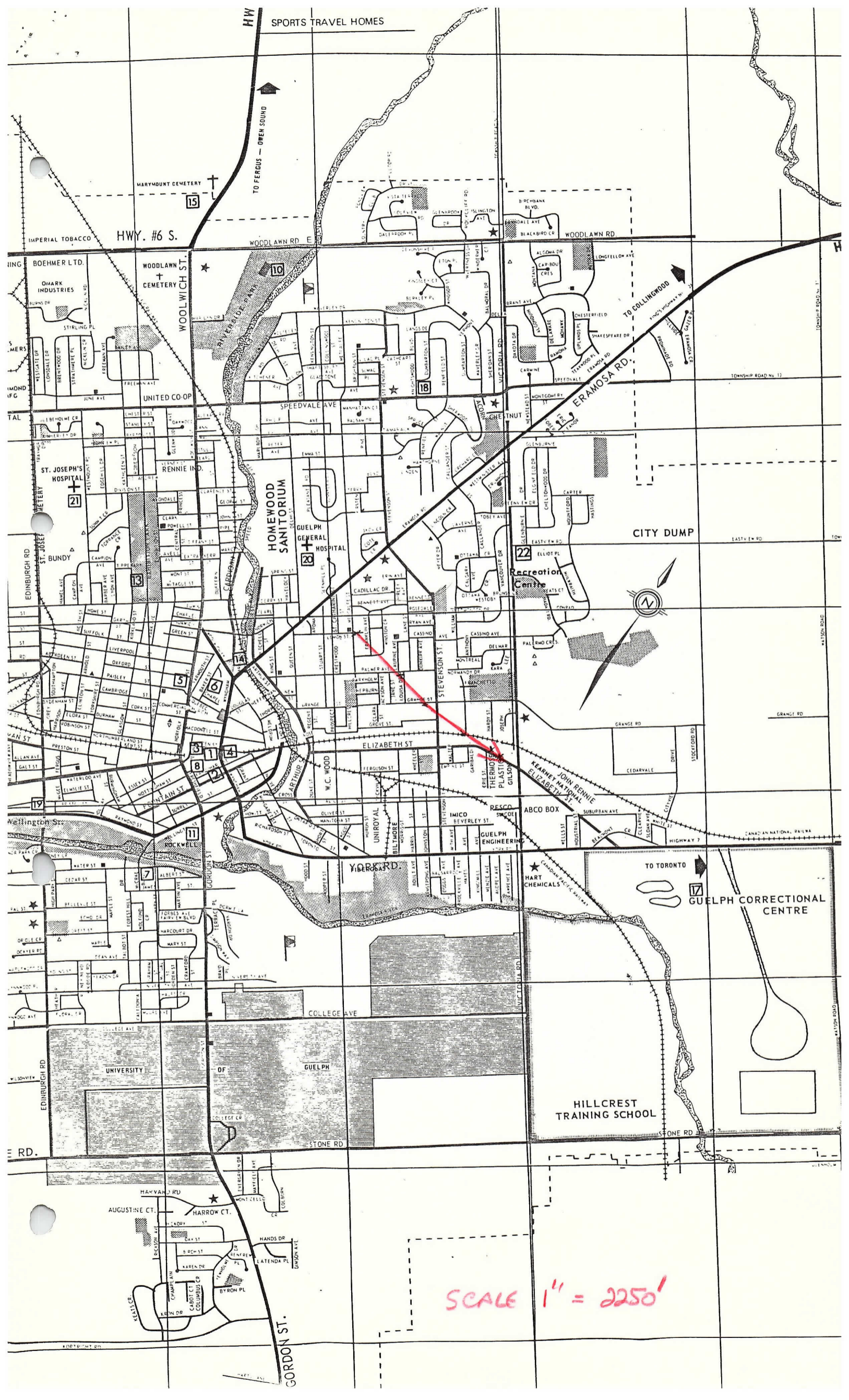

HWY. #6 S.

SPORTS TRAVEL HOMES

TO FEROUS - OPEN SOUND

TO COLLINGWOOD

ERAMOSA RD.

HOMEWOOD SANITORIUM

GUELPH GENERAL HOSPITAL

CITY DUMP

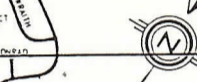

TO TORONTO

GUELPH CORRECTIONAL CENTRE

HILLCREST TRAINING SCHOOL

SCALE 1" = 2250'



NOTE:
 The Regional Municipalities of Durham, Haldimand-Norfolk, Halton, Hamilton-Wentworth, Niagara, Peel, Waterloo, and York are subdivided into cities and towns of greater area than exist elsewhere. This area of the Province delimited by is portrayed in greater detail in the SOUTH-CENTRAL ONTARIO enlargement, at right.

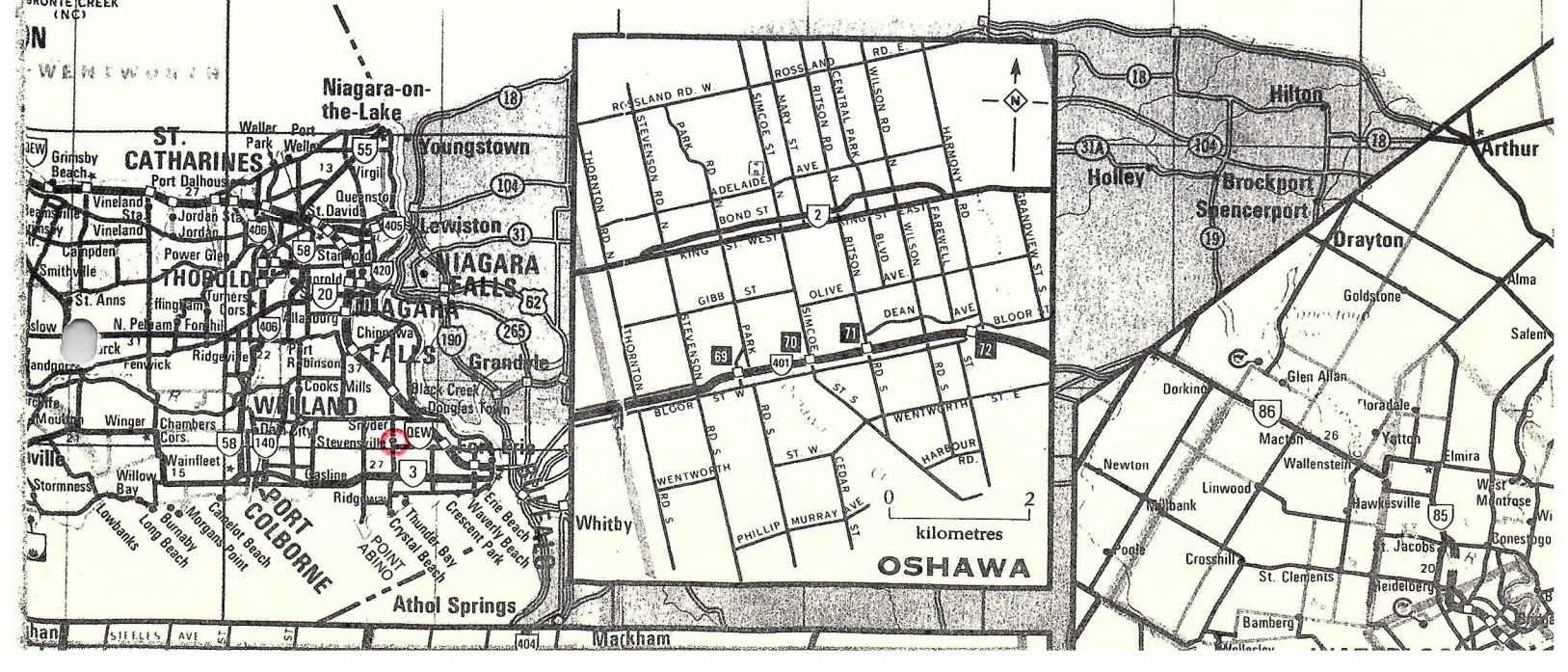



ADMINISTRATIVE

DISTRICT

CHELMSFORD

SUDBURY

COPPER CLIFF

CONISTON

CACHE BAY

WEBBWOOD

WESPANOLA

MASSEY

WILLISVILLE

ROOSEVELT

STALIN

GOSCHEN

ATTLEE

WALDIE

COX

DELAWARE

COSBY

MARTLAND

FALCONER

HARBOR

MCKINNON

LAWSON QUARRY

WILSON

ROOSEVELT

STALIN

GOSCHEN

ATTLEE

WALDIE

COX

DELAWARE

COSBY

MARTLAND

MASSEY

MCKINNON

LAWSON QUARRY

WILSON

ROOSEVELT

STALIN

GOSCHEN

ATTLEE

WALDIE

COX

DELAWARE

COSBY

MARTLAND

Saw
Cone
Shaped cloud
from Elora

(President) Salisbury ~~Lab~~
Mauritson, ~~Veterinary Supplies~~
Kitchener

Dr. 576-9730

Chris Ashman
846-0285

Elora

Geelph Correctional Centre

822-0028
824-1212
5 nothing of a
Person that's just
a guy limbs blown off
head

Geelph City Police

Const. Steven Caudle

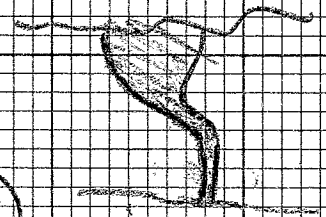

Storm track 3/4 mile long =
250 ft wide, (funnel about 50 ft)

Funnel seen by
direction of travel = travelling south
speed = very wide at top
colour = dark grey
noise = none noticeable
width = road width

grange + stevenson

touch-down

railroad

lifted up

Eliz-victoria

touch-down

lifted up

about 100-120 ft high
sudden lull, then saw it,
no rain!

6 cont. Rosmar welding, Ottaviano Rossi
 Stones picked up from yard and propelled through
 windows of neighbouring building. Storm seemed
 to divide into two components. (Andy's Rad Sec 4)
 Front door ripped off Boat smashed

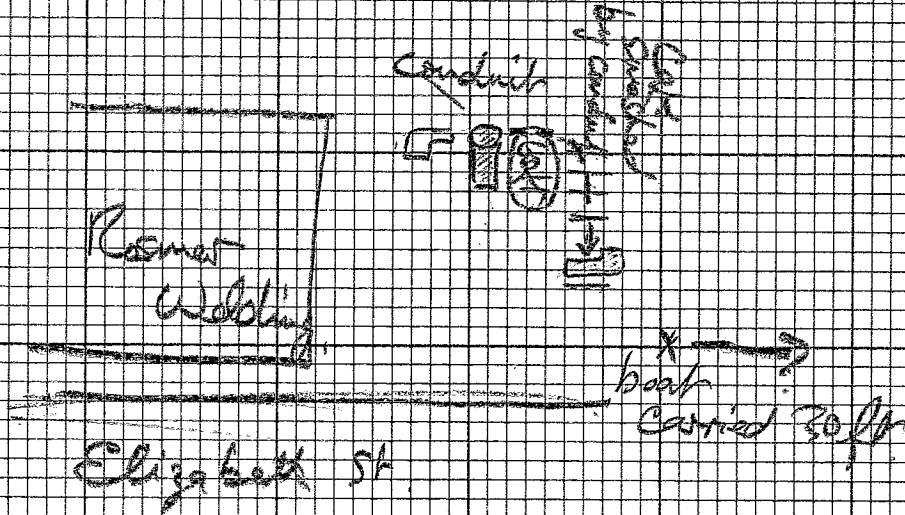

Suction Vortex Plot of damage.

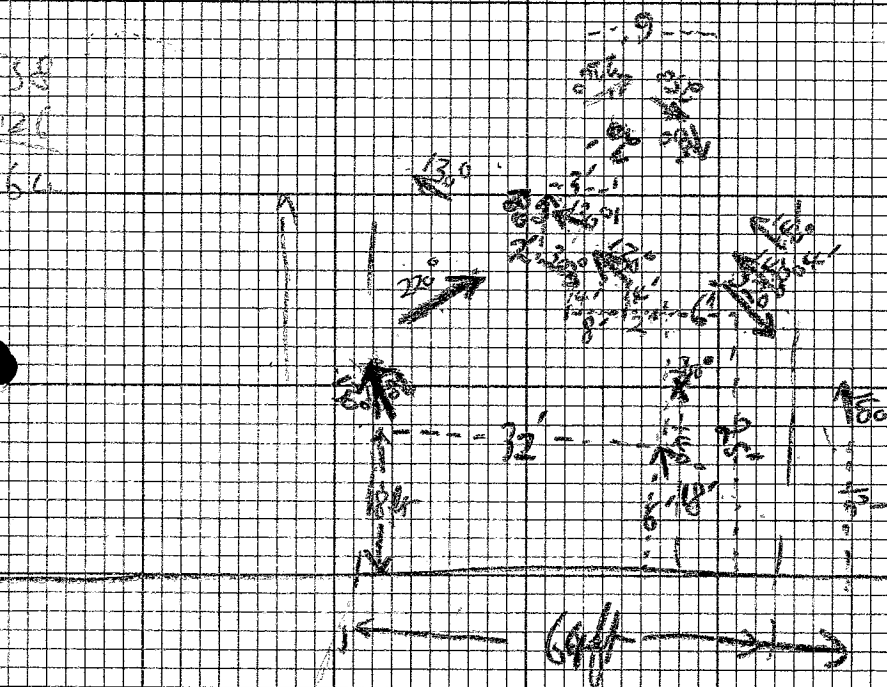

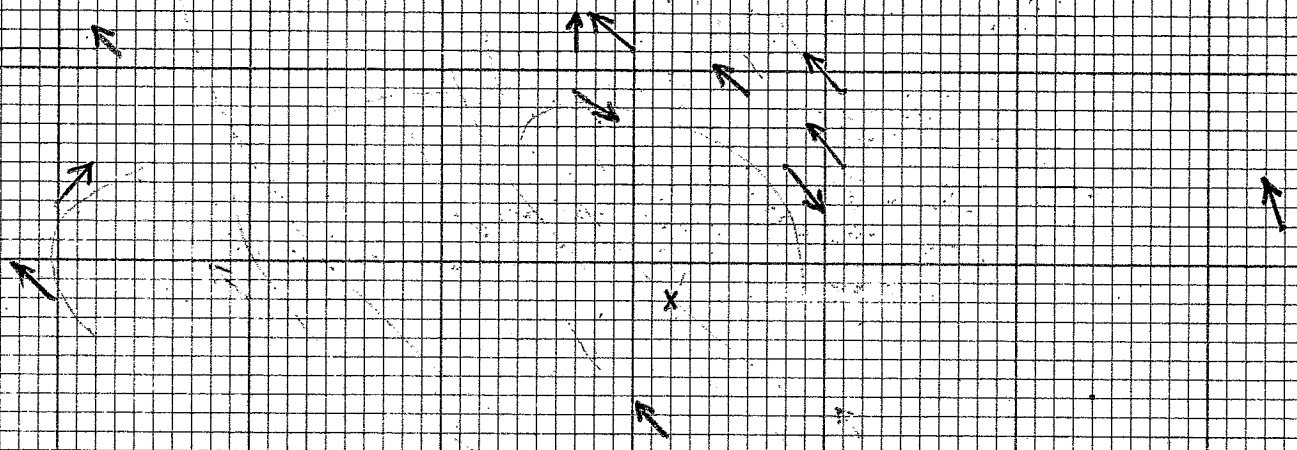

0 10 20 30 40 50

1 div = 1 ft.