

TORNADO PROJECT SUMMARY SHEET

ONT

1. DATE AND TIME WED JULY 26, 1978 (4) 1700 EDT: (6) 2100 EDT: (7) 2000 CDT
2. LOCATION OR PATH (attach map) 1 GUELPH (W-6) 0978-18
2 CAMBRIDGE 0978-19
3 VENTY WALKERTON 0978-20
4 ONAPING - WINDY LAKE (1 mi) 0978-21
5. STEVENSVILLE
6. LITTLE BOSKONSLEK
3. PATH LENGTH ☐ NOT KNOWN ☒ 0.8 <1mi; ☐ 1-4mi; ☐ 5-10mi; ☐ 11-50mi; ☐ LENGTH IF >50mi
4. PATH WIDTH 250 FT
5. TORNADO PART OF SQUALL LINE? ☒ YES; ☐ NO; ☐ UNKNOWN:
6. ANY UNUSUAL COLORATION? ☐ YES; ☐ NO; ☒ UNKNOWN
7. ANY UNUSUAL SOUND? ☐ YES; ☒ NO; ☐ UNKNOWN
8. IF ANSWER TO 6 OR 7 YES, ELABORATE;
9. LIST ANY ASSOCIATED PHENOMENA (1) NO RAIN AT TIME OF FUNNEL CLO
(Such as hail, vivid lightning heavy rain, no rain, etc.) FUNNEL CLODS ALSO REPORTED IN SCARBOROUGH, CAMBRIDGE AND WALKERTON
10. TOTAL DAMAGE ESTIMATE \$ U
11. TOTAL DEATHS NONE
12. TOTAL INJURED NONE
13. TOTAL HOMELESS NONE
14. LIST ALL REFERENCES STRATFORD BEACON HERALD, JULY 27, 1978.
THE STAR, TORONTO, THUR JULY 27, 1978
THE GLOBE & MAIL, TORONTO, THUR JULY 27, 1978
LONDON EVENING FREE PRESS, THUR JULY 27, 1978
TORONTO SUN. THUR JULY 27, 1978
THE SUDBURY STAR, JULY 27, 1978
KITCHENER-WATERLOO RECORD, JULY 27, 1978
TOWN AND COUNTRY CRICK, MILDMAW, AUG 3, 1978
FORT ERIE TIMES REVIEW, AUG 2, 1978.
MINDEN PROGRESS, AUG 2, 1978.
FRIDAY CITIZEN, PINGTANG, JULY 28, 1978
15. SUMMARIZE REMARKS PERTAINING TO (a) FUNNEL; (b) INTERESTING OR CAPRICIOUS EVENTS.

(a) Funnel seen by Constable Steven CAUDLE, Guelph City Police. who was within a few hundred feet of it at one point (Stevenson and Grange). He saw it moving aloft across the city towards him, saw it touch down at Grange & Stevenson where it was wide enough to cover the road from side to side. It then lifted up but touched down again at the railroad embankment, finally lifting at Elizabeth and Victoria. It was much wider at the top than the bottom and dark grey in colour and about 100 to 120 ft from tip to base of cloud. The constable described a sudden lull just before funnel appeared, then his car began to shake as it passed by. There was no rain.

(b) 2500 lb, 7ft diameter steel conduit pipe carried 60ft smashing 5 cars on its course. A man pushed from the front to the back of his house. Trees broken and roofing taken off Gino's Automotive Centre. A car and boat pushed 30 to 50 ft.

TORNADO PROJECT SUMMARY SHEET

F=0

ONT

1. DATE AND TIME WED, JULY 26, 1978. APPROX 1700 EDT
2. LOCATION OR PATH
(attach map) ONAPING - WINDY LAKE PARK
3. PATH LENGTH ☒ NOT KNOWN ☐ <1mi; ☐ 1-4mi; ☐ 5-10mi; ☐ 11-50mi; ☐ LENGTH IF >50mi
4. PATH WIDTH ☒ 5. TORNADO PART OF SQUALL LINE? ☐ YES; ☐ NO; ☐ UNKNOWN:
6. ANY UNUSUAL COLORATION? ☐ YES; ☐ NO; ☐ UNKNOWN
7. ANY UNUSUAL SOUND? ☐ YES; ☐ NO; ☐ UNKNOWN
8. IF ANSWER TO 6 OR 7 YES, ELABORATE;
9. LIST ANY ASSOCIATED PHENOMENA
(Such as hail, vivid lightning heavy rain, no rain, etc.)
10. TOTAL DAMAGE ESTIMATE \$ U 11. TOTAL DEATHS NONE
12. TOTAL INJURED NONE 13. TOTAL HOMELESS NONE
14. LIST ALL REFERENCES
THE SUDBURY STAR, JULY 27, 1978.
15. SUMMARIZE REMARKS PERTAINING TO (a) FUNNEL; (b) INTERESTING OR CAPRICIOUS EVENTS.
(a) no remarks but called a "twister".
(b) Numerous trees knocked over.

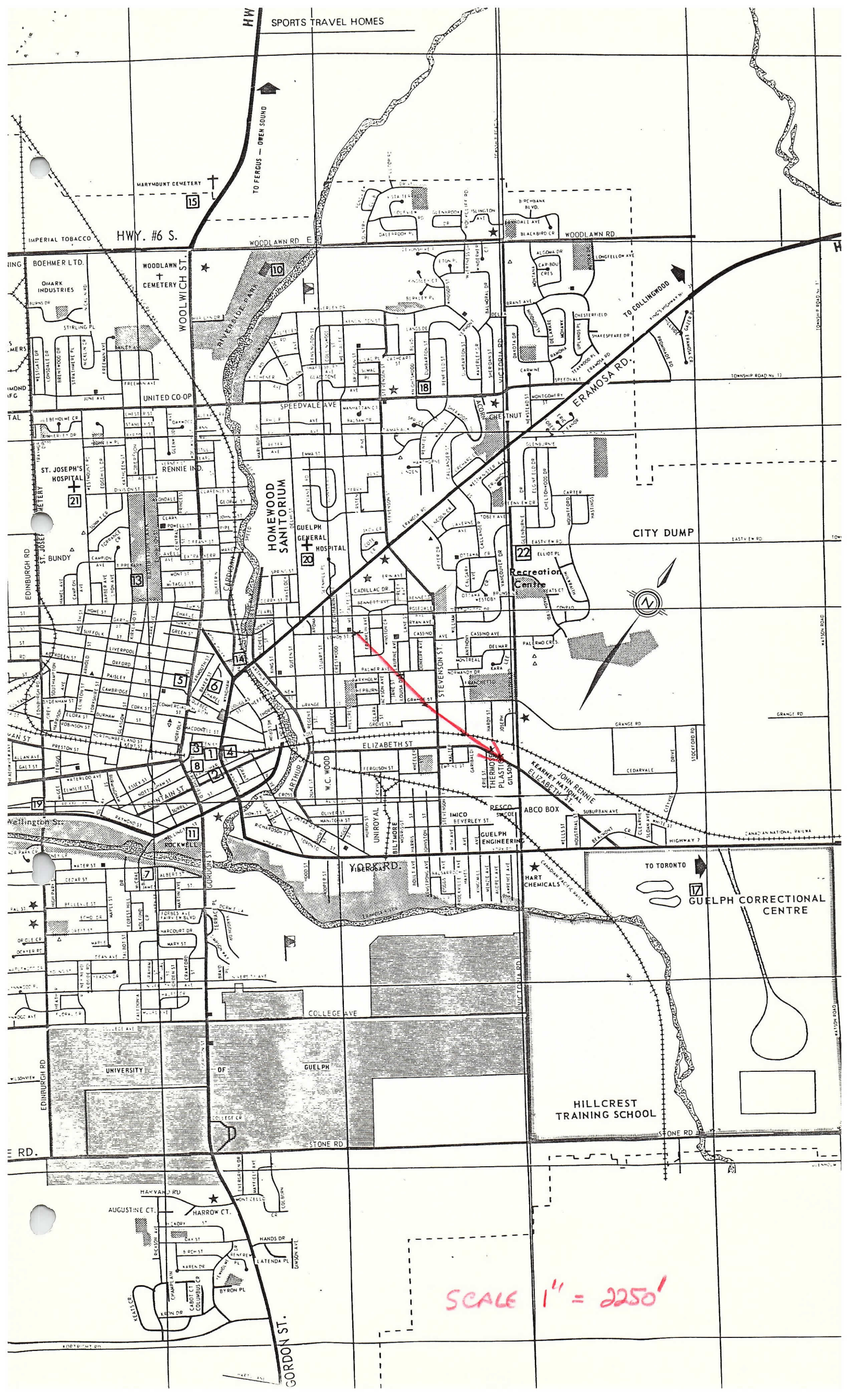

SCALE 1" = 2250'

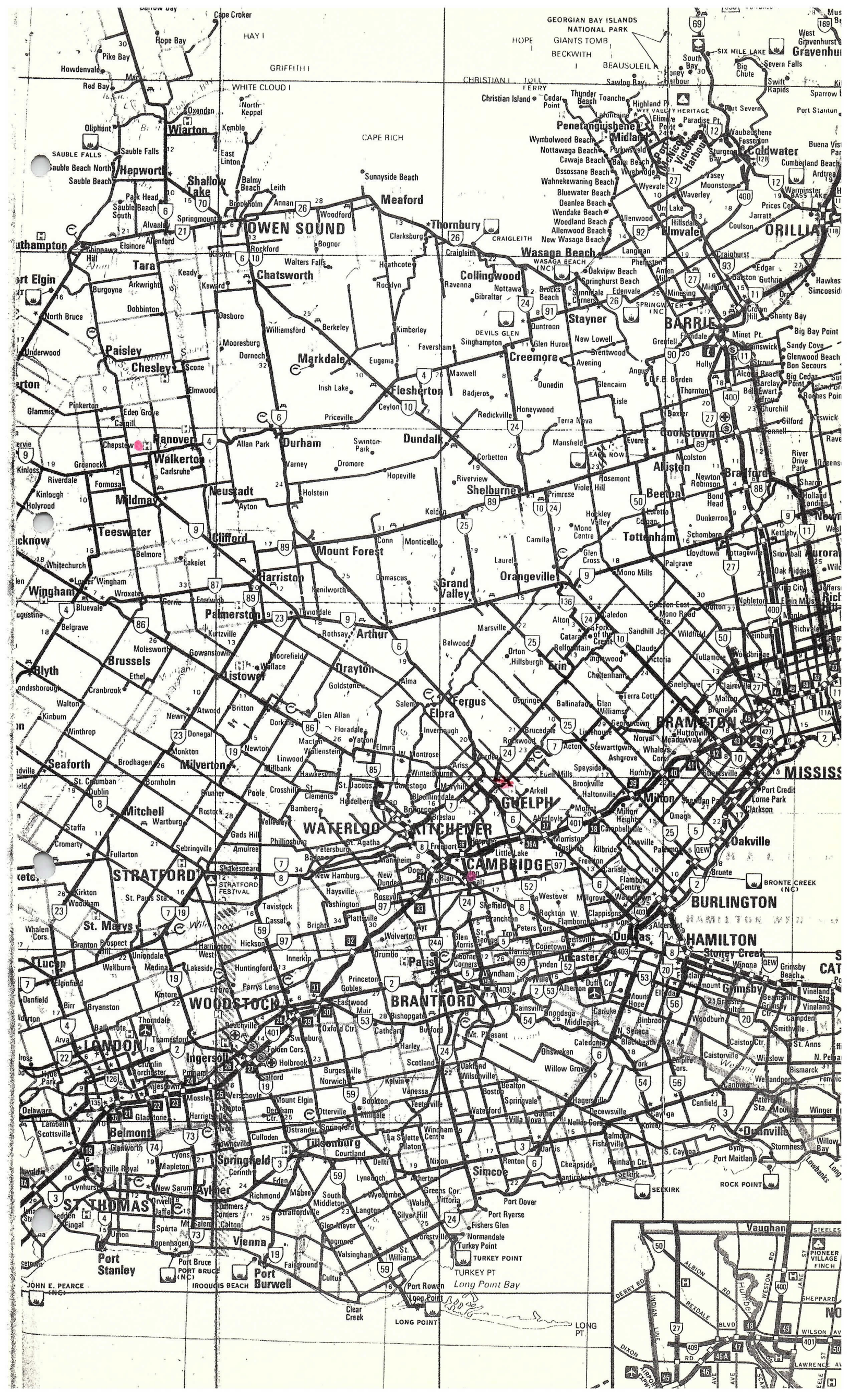

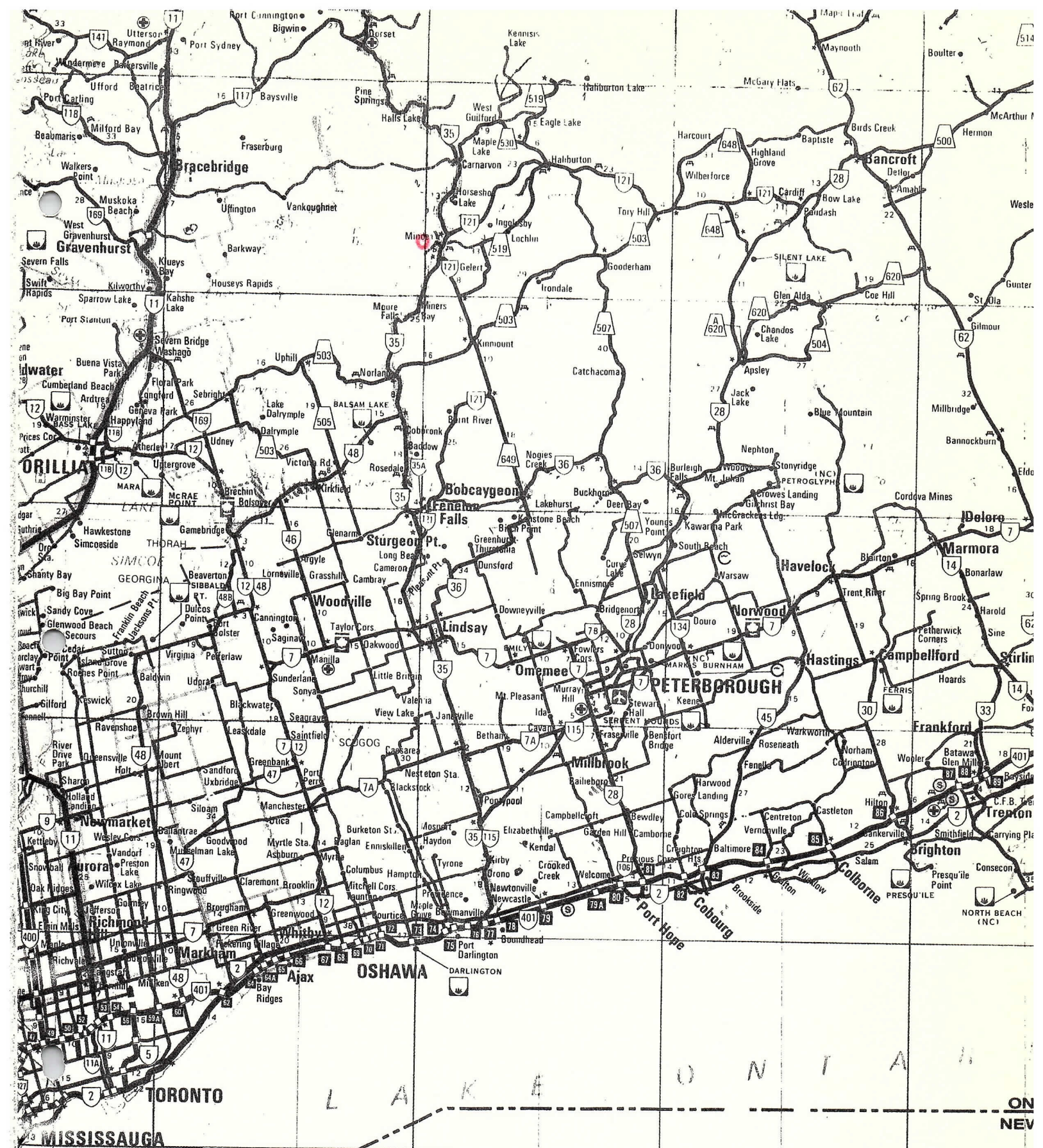

NOTE:
The Regional Municipalities of Durham, Halton, Hamilton-Wentworth, Niagara, Peel, Waterloo, and York are subdivided into cities and towns of greater area than exist elsewhere. This area of the Province delimited by is portrayed in greater detail in the SOUTH-CENTRAL ONTARIO enlargement, at right.

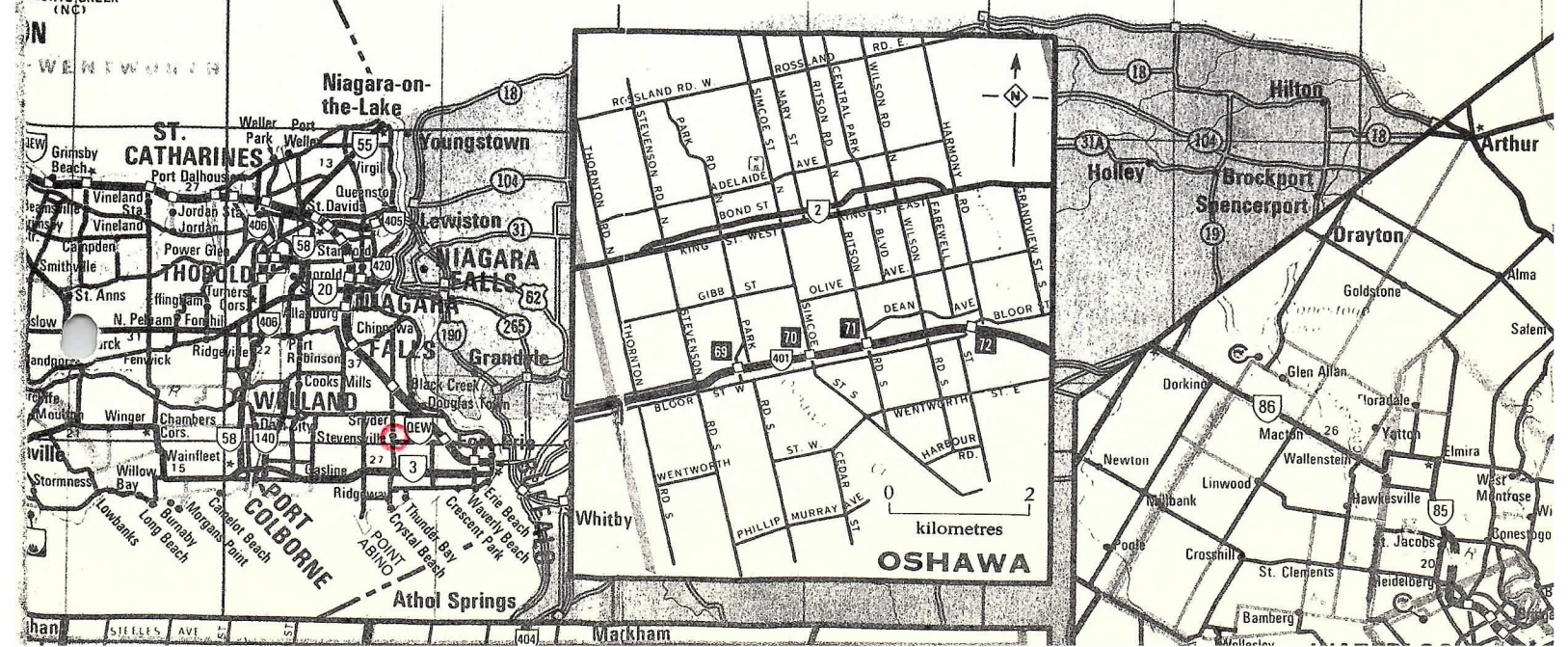



2 Juncos Automobile 8.15 pm
3 352-3524 Cliza bed sh.

Roofing stripped off, which blocks
pushed 20 ft. 3 chimneys demolished
and windows broken out.
Advertising signs carried 250 yds
to stop light at Victoria. Roofing
material forced into car windows
teal about 60 ft along track.

at 3, two courses of concrete blocks taken off and deposited about 6 ft along track
 5:20 PM Storm

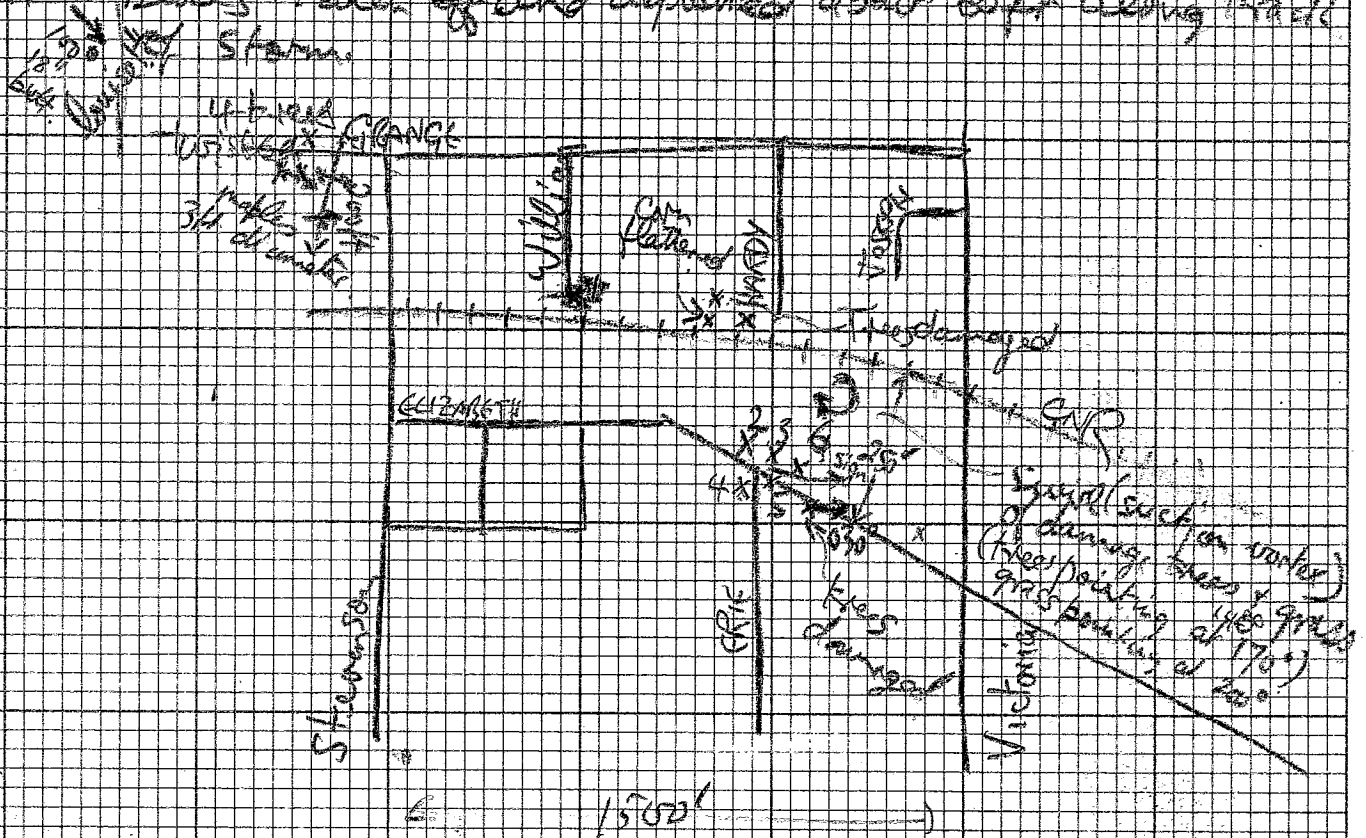

Hopper broken off.
 Fence damaged

Any more. I William W., saw something but it was
pushed from front of his house to the back (about safe) but
unhurt. "It all happened in a moment". No rain
until after the hail.

b. 250 lb conduit ~~4~~ 4 in. diameter, lifted up and carried squashing 5 carb.

Rosmar Welling

Saw
Cone
Shaped cloud
from Elora

President Salisbury ~~Lab~~
Munition, Kitchen

Dr.

576 - 9730

Chris Graham

846 - 0285

Elora

Guelph Correctional Centre

822 - 0028
824 - 1212
Nothing of a
serious nature just
a few limbs blown off
trees

Guelph City Police

Const. Steven Caudle

Storm track 3/4 mile long -
250 ft wide, (funnel about 50 ft high)

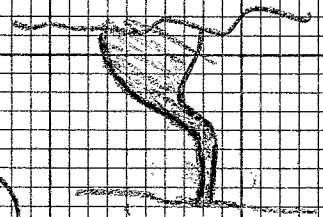

Funnel seen by

Grange & Stevenson

touch-down

direction of travel - travelling south

lifted up

speed = very wide, at top

colour = dark grey

railroad

touch-down

noise = none noticeable

Eliz-Victoria

lifted up

width = road width

about 100-120 ft high

sudden lull, then saw it,
no rain!

6 cont. Rosmar Welding. Ottaviano Rossi
Stones picked up from yard and propelled through
windows of neighbouring building. Storm seemed
to divide into two components. (Candy's Rad Service)
Front door ripped off. Boat smashed

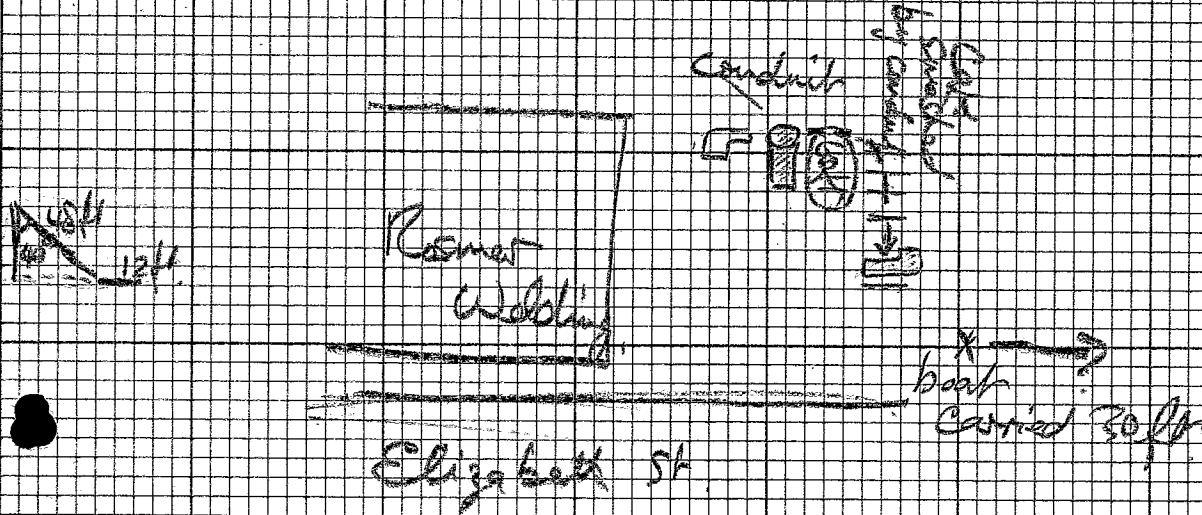

Suction Vortex Plot of damage.

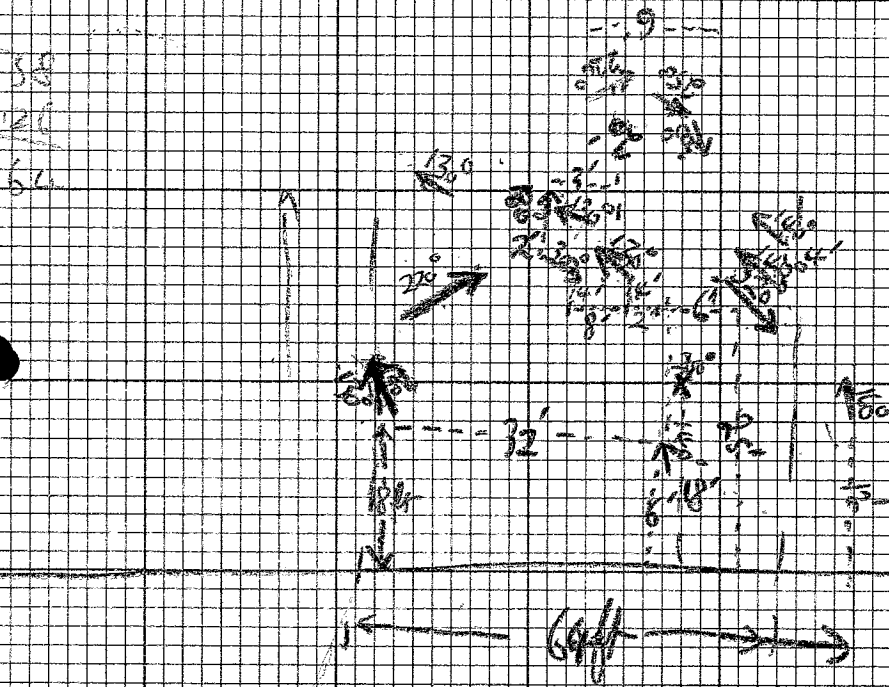

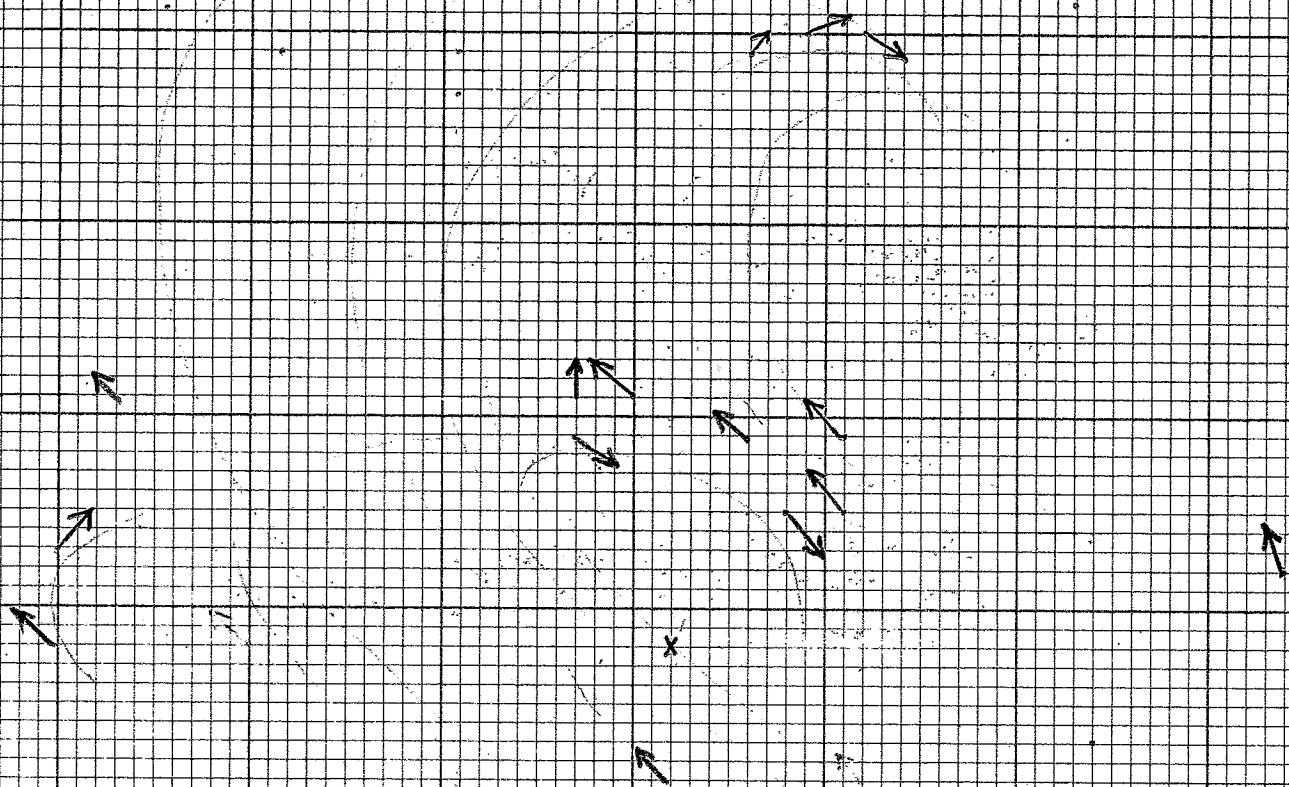

1 div = 1 ft.