

3

TORNADO PROJECT SUMMARY SHEET

F=1

ONT

SUNDAY

1. DATE AND TIME 16-4-1961 SHORTLY BEFORE 0700 EST

2. LOCATION OR PATH (attach map) ALONG CONCESSION 4 HARWICH TOWNSHIP
 ① NEAR BLENHEIM FROM 350 (± 100) 06961-01

3. PATH LENGTH NOT KNOWN <1mi; 1-4mi; 5-10mi; 11-50mi; LENGTH IF >50mi

4. PATH WIDTH UNKNOWN 5. TORNADO PART OF SQUALL LINE? YES; NO; UNKNOWN:

6. ANY UNUSUAL COLORATION? YES; NO; UNKNOWN

7. ANY UNUSUAL SOUND? YES; NO; UNKNOWN

8. IF ANSWER TO 6 OR 7 YES, ELABORATE;

9. LIST ANY ASSOCIATED PHENOMENA (Such as hail, vivid lightning heavy rain, no rain, etc.)

10. TOTAL DAMAGE ESTIMATE \$ THOUSANDS TWO BARNs ALONE \$15,000 11. TOTAL DEATHS NONE

12. TOTAL INJURED 13. TOTAL HOMELESS NONE

14. LIST ALL REFERENCES WINDSOR STAR APRIL 17 1961

15. SUMMARIZE REMARKS PERTAINING TO (a) FUNNEL; (b) INTERESTING OR CAPRICIOUS "MINATURE TORNADO". "KNOCKED OUT BARNs, CHICKEN COOPs, HOG PENS. EVENTS. TWO GREENHOUSES. HEAVIEST DAMAGE NEAR BLENHEIM BARN TORN TO MATCHWOOD AT ABOUT 0645 EST. GALVINIZED IRON ROOF BLOWN FOR DISTANCES UP TO A MILE

WORKSHEET

IDT006961-01

① ORIGIN x 17414900
 y 4685100

⑤ Standard Error S_x
 $C=200$

② LIFT-OFF x_1 17415100
 y_1 4683900

⑥ Standard Error S_y
 $C=200$

③ $(x_1 - x) = 200$

④ $(y - y_1) = 1200$

⑦ DAMAGE LENGTH

$$L = [(x_1 - x)^2 + (y - y_1)^2]^{1/2}$$

⑧ $\alpha = \tan^{-1} \frac{|y - y_1|}{|x - x_1|}$

③+④ $\rightarrow r, \theta = 1216$

$x \leftrightarrow y = 80$

⑨ Standard Error $S_L = (S_x^2 + S_y^2)^{1/2}$

⑤+⑥ $\rightarrow r, \theta = 283$

⑩ $\beta = \frac{\tan^{-1} S_L}{L}$

⑦+⑨ $\rightarrow r, \theta$
 $x \leftrightarrow y = 13$

NE Quad $\phi = 90 - \alpha$

SE quad $\phi = 90 + \alpha$

SW quad $\phi = 270 + \alpha$

NE quad $\phi = 270 - \alpha$

⑪ $\phi = 350^\circ$

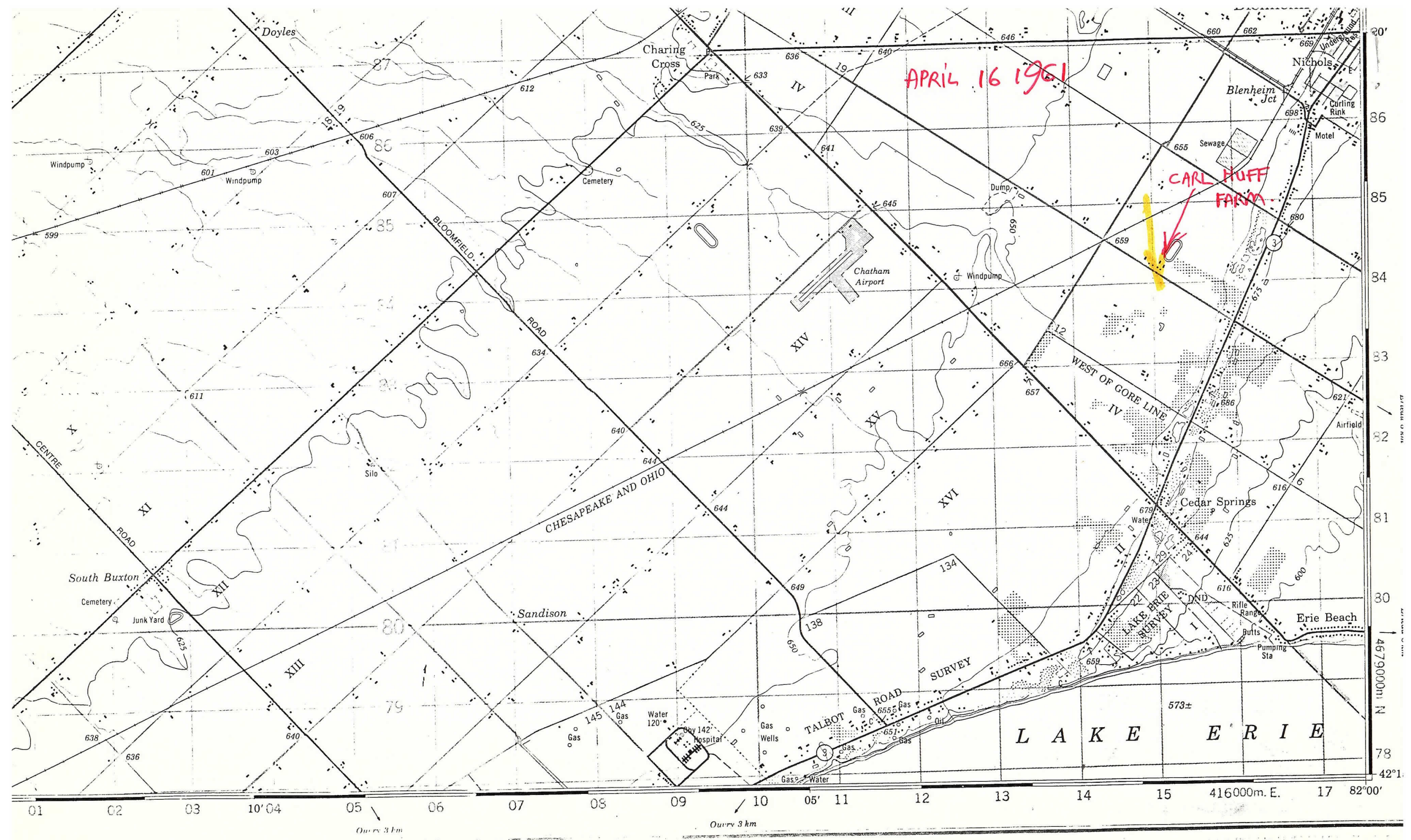

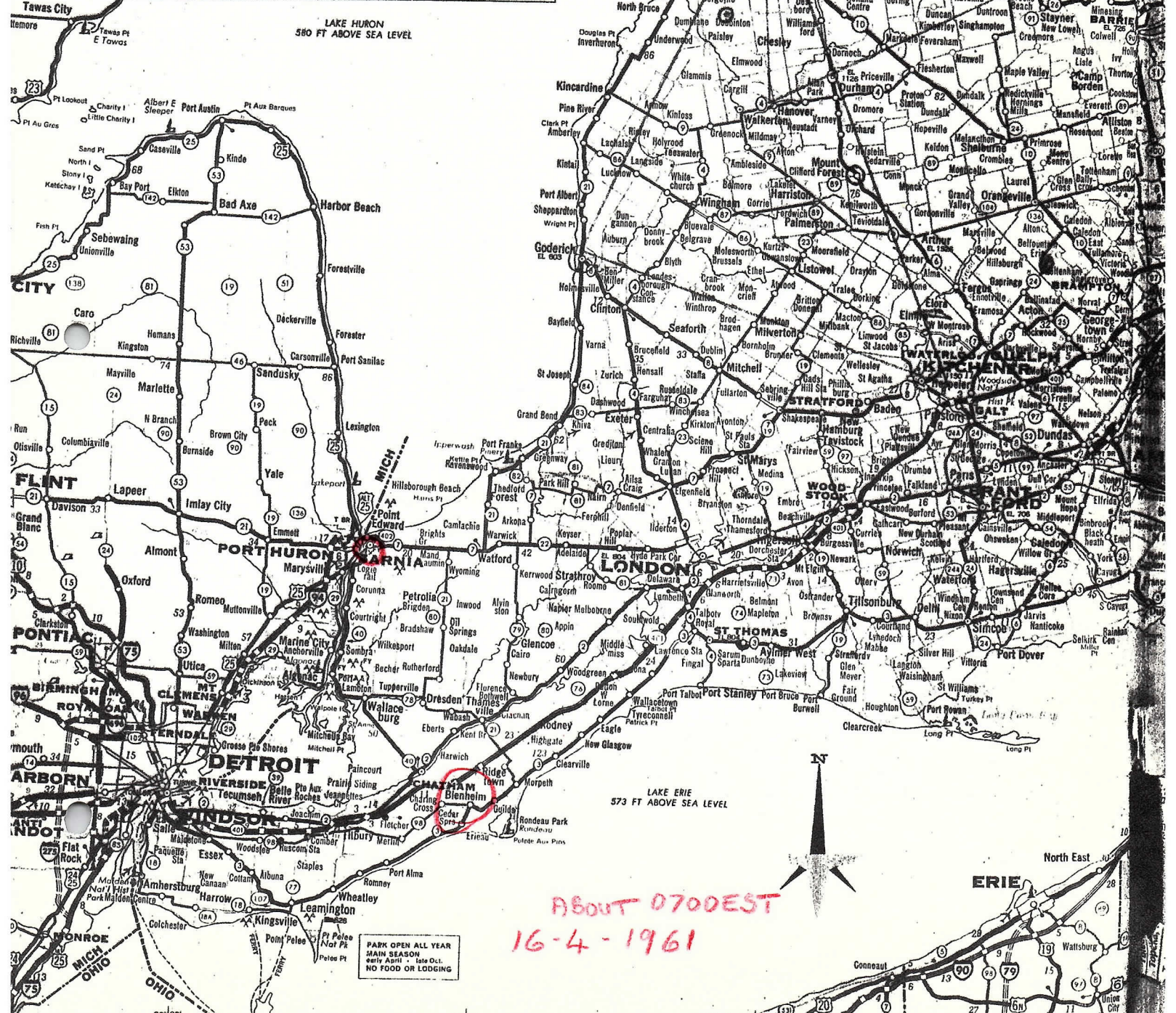
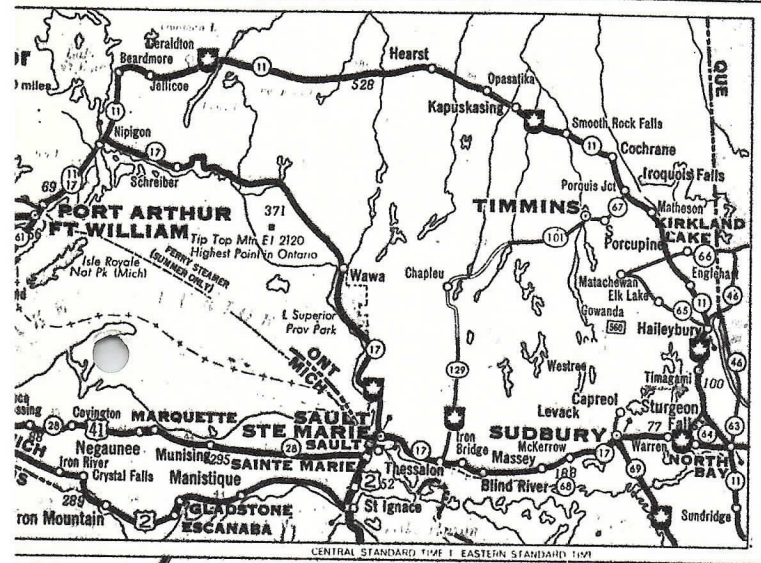
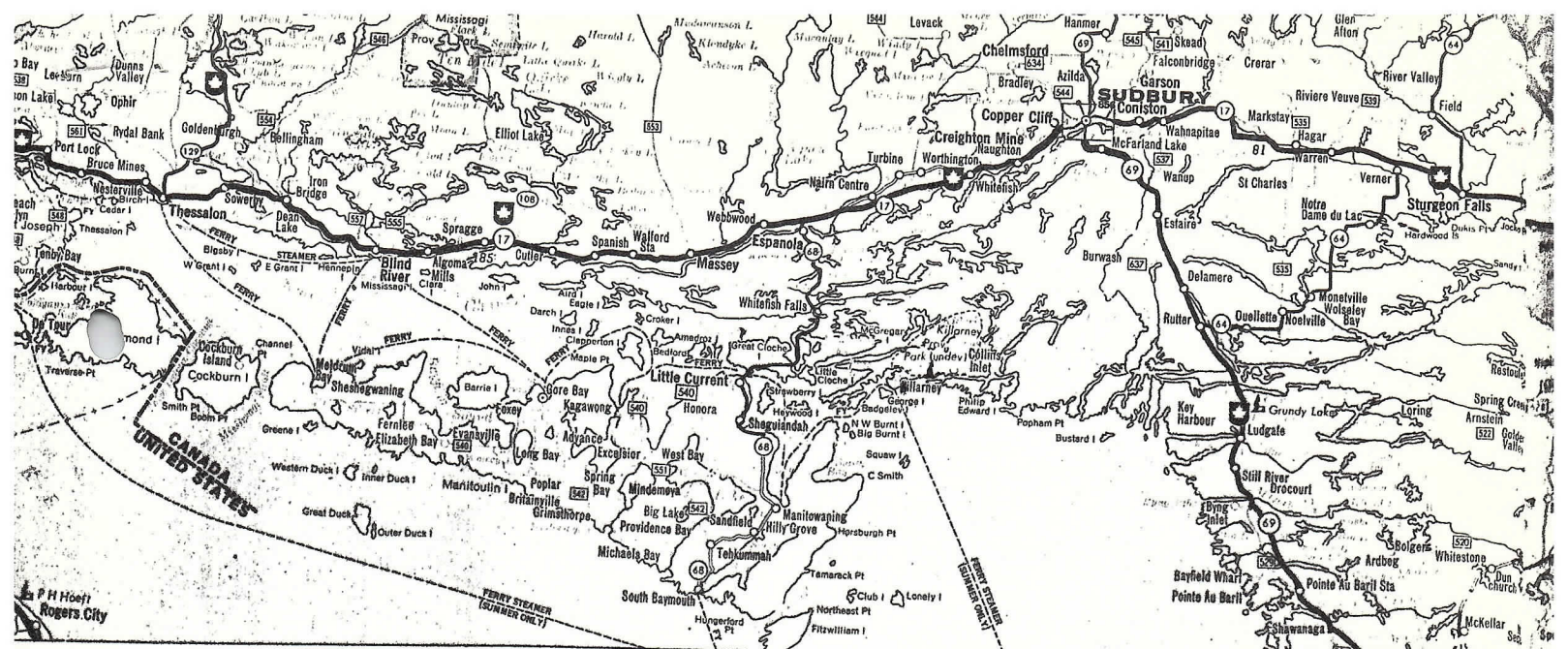

Power and telephone lines were downed as light and communication was concerned. The storm recalled the tornado which struck the Sarnia area May 22, 1953, causing damage estimated at \$5,000,000. Sarnia was the hardest hit community in that storm, when about 500 were left homeless.

Sarnia Airport Hit, Damage \$100,000

SARNIA—Hardest hit by the storm, which snapped off trees and hydro wires, was the Sarnia Airport, located four miles north of Sarnia off Highway 7, where one building and two aircraft were destroyed in a matter of minutes. Damage in the Sarnia area was estimated around \$100,000.

Eric Colbert, president of Sarnia Airport Ltd., and Sarnia Airlines Ltd., revealed Sunday that damage at the airport will reach between \$70,000 and \$90,000. At the airport, one small

JUN 13 1960

rs Survey led Crops

were checking damage radiic storm Saturday eve- is area of about \$200,000,

to the south. No one was reported injured.

Bill Snelgrove, R.R. 6, Walceburg said the barn owned

Heads rship Lis

rted from a lightning b at the area Saturday ni and Mrs. Ed. Capiau, C

ls content within less n hour. Firemen were o save other farm build one of them within less 0 feet of the house.

Mrs. Ivan Capiau wa st to notice the fire. is mopping up rain

Starts Fire lding Gue

Page 34) winds that hit 100- through Lambton a ich farmland with F ghtning damage.

wister which hit t still definite to 000,000 mark

Tornado Hits Kent

Damage Runs Into Thousands

By BLAIR MCKINNON of The Star's Chatham Bureau

BLENHEIM — A miniature tornado blitzed a section of Harwich Twp. shortly before 7 a.m. Sunday, knocking out barns, chicken coops, hog pens, two greenhouses and causing thousands of dollars damage. There was no loss of life.

Heaviest damage was caused along Con. 4, Harwich near Blenheim, where a barn containing corn, hay, oats, a hay-loader, tobacco planters and other machinery, was torn to matchwood by the intensity of the blow.

This barn on the farm of Carl Huff, was ripped out at approximately 6:45 a.m., and parts of it including a new galvanized iron roof were blown for distances up to a mile.

The main part of the beamed roof blew over onto the property of Cecil Crawford next farm, ripped apart a chicken house there.

Damage at these two farms alone will estimate at least \$15,000, with the preponderance of the Huff farm.

CARL HUFF

676-3375

SUN APRIL 16 1961

The Windsor Star Library